



**B**<sup>15</sup>  
IN PRODUCTION





# B<sup>15</sup>

BAYLISS HULL FIFTEEN:  
IN PRODUCTION





*"The trend in the custom sportfish yacht industry is that the boats are getting bigger and bigger. This is the first time Bayliss Boatworks has been able to offer a boat of this size this close to delivery."*

Bayliss Boatworks Hull 15 is available, and is scheduled for delivery late summer / fall 2012. At 80' with a 5 stateroom, 5 head layout, the boat is designed not only to travel but also to fish effectively. Hull 15 is at the stage of construction that is perfect for a new owner to be able to choose interior details, soft goods, electronics, A/V, etc. For more information, **visit our website or schedule a visit to tour our facilities and Hull 15 in person.**



# HULL 15 DETAILED



**Interior:** Five stateroom / five head layout. Master stateroom full beam forward with in-suite refrigerator, sofa, king berth, hidden storage. Port VIP guest with queen berth. Starboard VIP guest with single berth, low/hidden Pullman over. Aft crew stateroom with two bunks. Aft captain stateroom with bunk lower and hidden Pullman. Air actuated components: bunk tops in master stateroom, port guest stateroom, starboard guest stateroom, salon door. Teak/Maple floors in all heads and galley/dinette area. Samsung LED TVs throughout, teak wainscoting, teak carpet borders. All veneers from one teak log.

**Cockpit:** Mezzanine style/salon door to port. Stainless in deck refrigerator/freezer, three stainless refrigerator/freezers in mezzanine. Transom fishbox/livewell. Flooded four-pump live well supply system. Cockpit grill. Tackle drawers. Pocketing gaff locker doors. Air actuated drop-down TV/Monitor.

**Bridge:** Center console layout. Wrap-around seating forward with island table/freezers. Two Release helm chairs. Four stainless refrigerator/freezers. Rod storage. Storage cubby with recycling container.

**Electronics:** Owner selection TBD. Recommended supplier Commercial Marine Electronics

**A/V:** Final selections TBD. Current with Crestron, Kaleidescape components. Supplier AVID Sound

**Features:** 2 sets VEEM propellers with splines. Teak toe rail, aft cockpit bulkhead, and transom. Tower by Palm Beach Towers. Electrical system design by Wards Marine Electronics. Fishing camera system. Two A-SEA 25 Shore Power converters. Two 100 amp Shore Power inlets. Six Deep Sea LED Underwater Lights. FCI 1800 gpd watermaker. Spot Zero R/O System. Chilled water. A/C system and more.

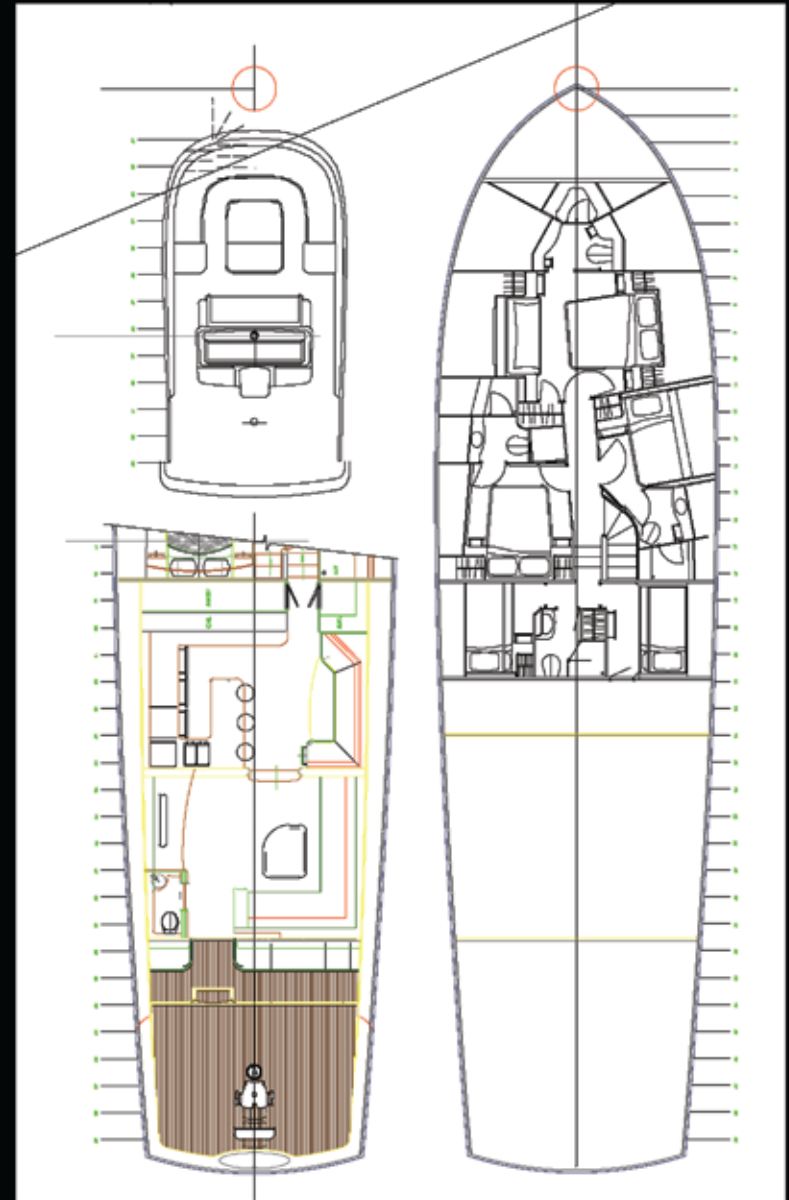

80 feet | Beam: 21 feet, 3 inches | Draft: 5 feet, 8 inches | Two MTU M-94's @ 2600 horsepower each  
Two 38 kw Northern Lights generators | Dry weight: 115,000 pounds | Fuel: 3,200 gallons | Water: 450 gallons  
Holding tanks: 300 gallons